

For Lease

1650 19th St. Santa Monica CA 90404



For More Information.

CONTACT:
tel. 310/839/3333
fax. 310/839/3382
www.lancelotcommercial.com

LANCE LEVIN, PRESIDENT
lance@lancelotcommercial.com

OFFICE LOCATION
8924 LINDBLADE STREET
CULVER CITY, CA 90232

NOTE: All measurements are approximate and while the information furnished comes from reliable sources, we assume no liability.
Lance Levin: DRE # 01128388 Jonathan Wolk: DRE# 01228058

"Regardless of the professional broker you choose, it is critical to have a broker who is well versed in all aspects of the market in which you are dealing. You will not find a better brokerage company than Lancelot Commercial with this kind of track record."
- Lance Levin, President & Jonathan Wolk, Senior Associate

For Lease

1650 19th St. Santa Monica CA 90404



Freestanding Warehouse Building

AVAILABLE SF: 6,000 SF
LAND SF: 8,000

- Freestanding warehouse building with paved and fenced yard
- Uses include Manufacturing, Distribution, Storage, Flex, Studio, Showroom
- Parking nearly 2/1,000
- Front street and alley access
- Between Olympic and Colorado
- Just three blocks to 10 Freeway on/off ramp at 20th Street
- For Lease: 1.50 SF Gross



LANCELOT
COMMERCIAL INDUSTRIAL BROKERAGE

For Lease

1650 19th St.

Created by **PlanOmatic** 2009
Measurements may not be 100% accurate
Floor plans are provided for convenience only
Rooms sizes are not used to calculate area

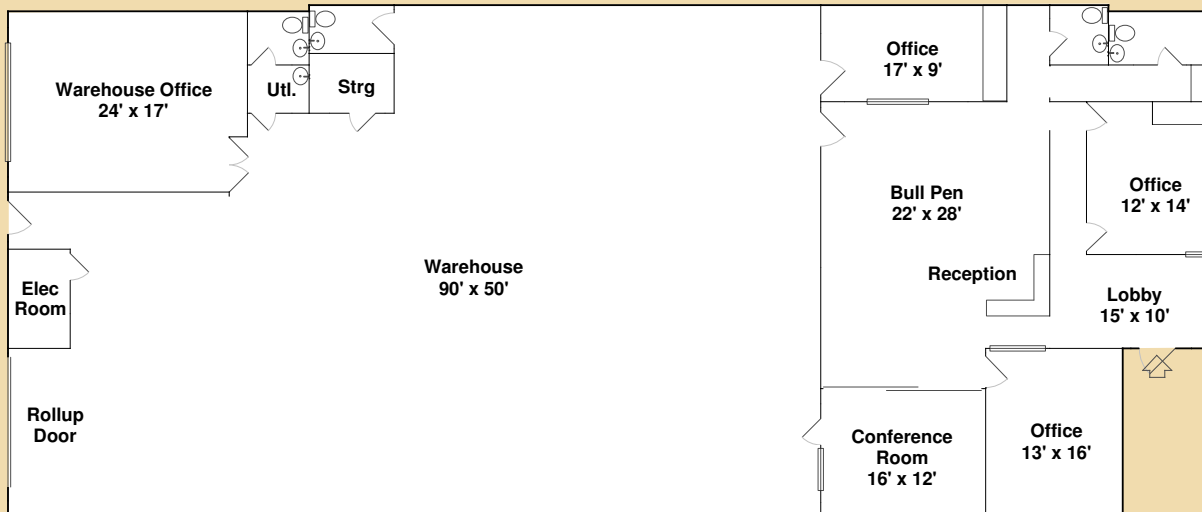

"Regardless of the professional broker you choose, it is critical to have a broker who is well versed in all aspects of the market in which you are dealing. You will not find a better brokerage company than Lancelot Commercial with this kind of track record."

- Lance Levin, President & Jonathan Wolk, Senior Associate